

OnCube is the future!

Latest generation packing process management software

ADMINISTERING MEDICINE AND PATIENT INFORMATION, ORGANISING ORDERS

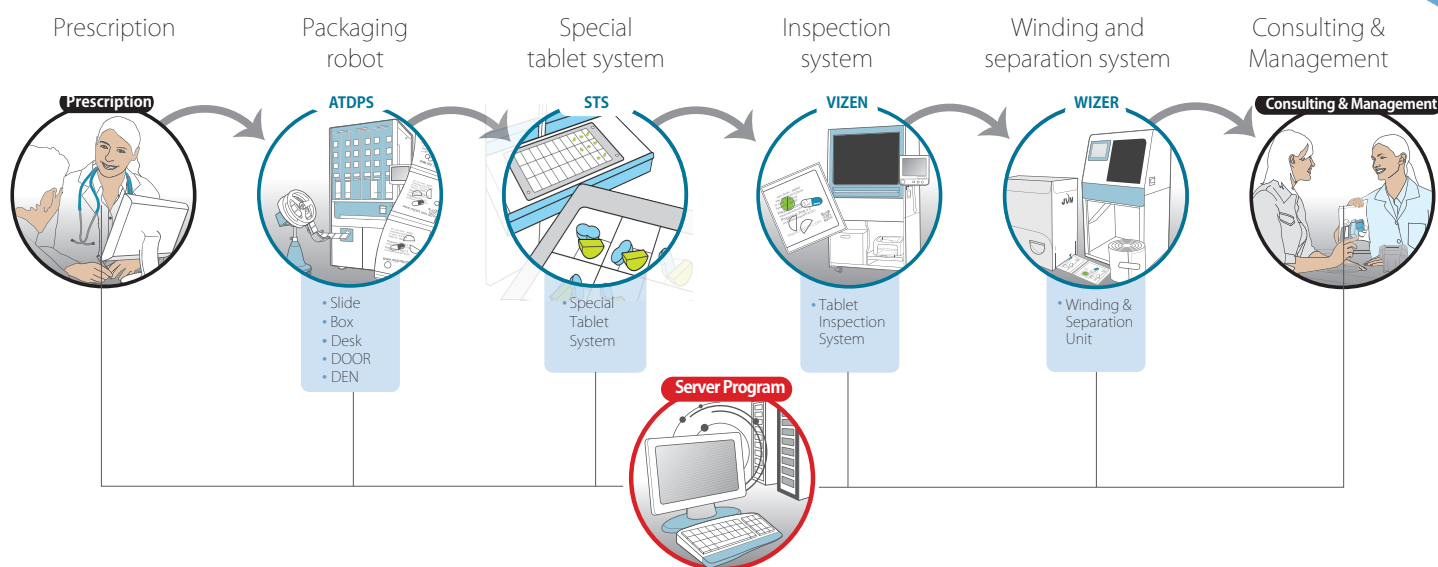

OnCube combines an efficient packaging process with maximum increased patient safety. It allows for the entire production process to be managed, operated and monitored, offering extensive functionality for processing patient and medication data from an OCS file (a file containing the prescription details which is generated by the pharmacy or hospital system), management of medication and system users.

From a single central database it is possible to control the packaging machines. OnCube is also able to work with the other optional devices such as the VIZEN (pouch inspection system), the WIZER (winding and separation of pouch strings per patient) and the STS LS (for dispensing special medication, or parts of tablets). A standard interface for your country is used for the link to your Pharmacy Information System.

What to expect with OnCube Software:

- Workflow control for the total order process in one program.
- Medication data administration using a unique selectable number registration.
- Patient & prescription data scanning and processing.
- Password protected and user-set security.
- Current status of each machine can be quickly and seen on display.
- Production reports generated by system.
- Extensive error logging.
- Supports 2D GS1 barcode functionality.
- One database contains all data for organisational ease.
- Software is G(A)MP compliant; hardware is GMP compliant.
- Displays which machine is most efficient to use for specific operations.
- Optimum planning via the STS Load Station for special tablets.
- User-friendly interface.
- System always accessible – even during production.
- Access to OnCube Database by 3rd party software using the OnCube webservice.
- Optimised algorithms calculate best order for production on each machine.

Upgrade of the OnCube Software gives you:

MEDICINE ADMINISTRATION

- Possible to deblist tablets in separate containers with own barcode/lotnumber. Possible per whole or partial tablets.
- Deblist calculation is possible. Based on a set period (weeks or days) a prediction is made for the deblistering.
- Canisters can be assigned to all machines or to a specific machine group. Better assignment to distribute jobs!

JOB HANDLING

- Manual or automatic buffering. Identification of the hospital is possible when ID is in File or Filename. Configurable per hospital.
- Optional storage of OCS file in OnCube. Possible to do one job more than once!
- Patients can be shifted to and from the machines as long as the job is not yet produced.
- Prepackaging can be done. Stored for later use with or without the patients name.
- Possible to create a group of machines. Canisters can now be assigned to all machines or to a specific machine group.
- Multilingual printing possible. Languages can be set per location. Main medication and pouch features can be translated per location (day of the week, color or shape of the medicine, etc.)
- Reverse dispensing is possible per location.
- To adjust Print layout only one line of medication needs to be changed. Then it repeats over the pouches automatically. Optional print fields can be rotated.
- Automatic processing possible. Entire calculation process is done on the OnCube Station before production starts.

AUTHENTICATION

- Authentication per action. Access level is defined per group. Per action it is possible to set the authentication level. automatic, username/password or 4eyes.
- Action traceability. Report in the reportsection. For all users or a specific user per period.

VIZEN

- Pill images can be loaded in the medicine menu and images of pouches are visible in Track and trace-menu through integration of the VIZEN.

THIRD PARTY ACCESS

- XML file export is supported.
- Web service access is supported.

ADMINISTRATION

- A faster reporting tool is created.

HARDWARE SUPPORT

- BOX, Slide, Door, Desk, DEN, NS(P), ACRS2, ACRS3 and future machines.

Integration of a personal radio frequency code

A plastic chip with unique radio frequency identification (RFID) replaces user name and password login. By holding the chip against the reader access is gained to the system and all actions are logged per user.